

# NATIONAL CONVENTION HALL



Exterior that invokes the image of a seashell

## From large international conferences to concerts

National Convention Hall is the core facility of PACIFICO Yokohama. It is also one of the largest convention halls in Japan. It has an adjustable stage in addition to over 5,000 seats. It can be used for multiple purposes, from conferences to concerts, ceremonies, and events.

Only  
One

national  
convention hall  
in east Japan

5,000  
seats

in total of  
three floors

8ch  
5 booths

simultaneous  
interpretation

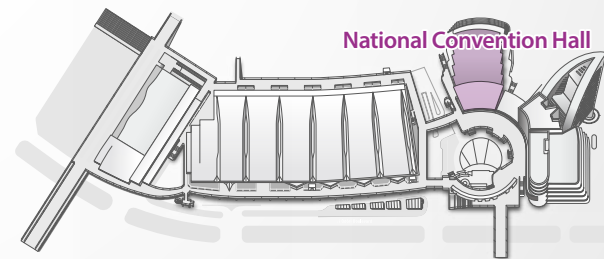

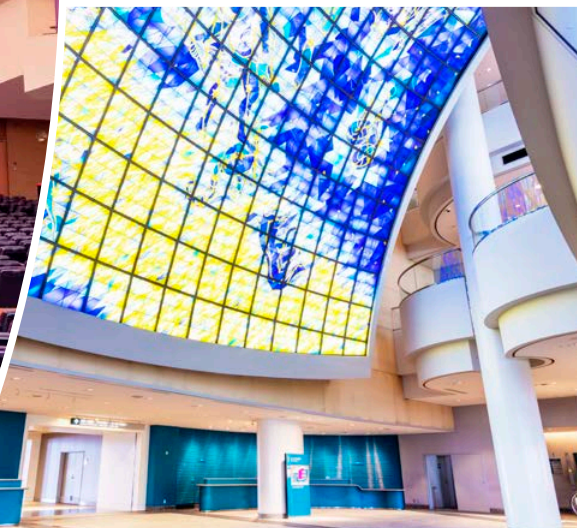
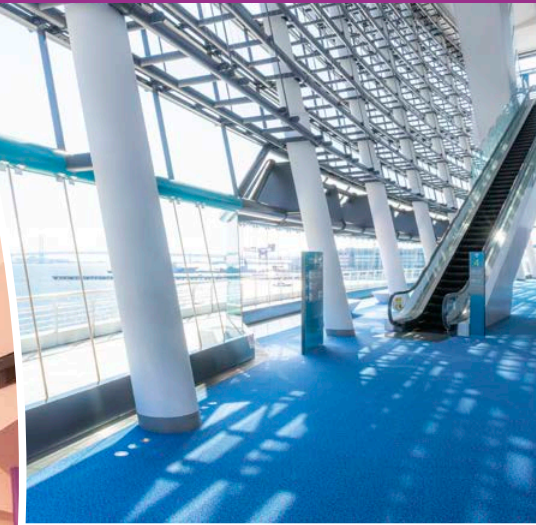

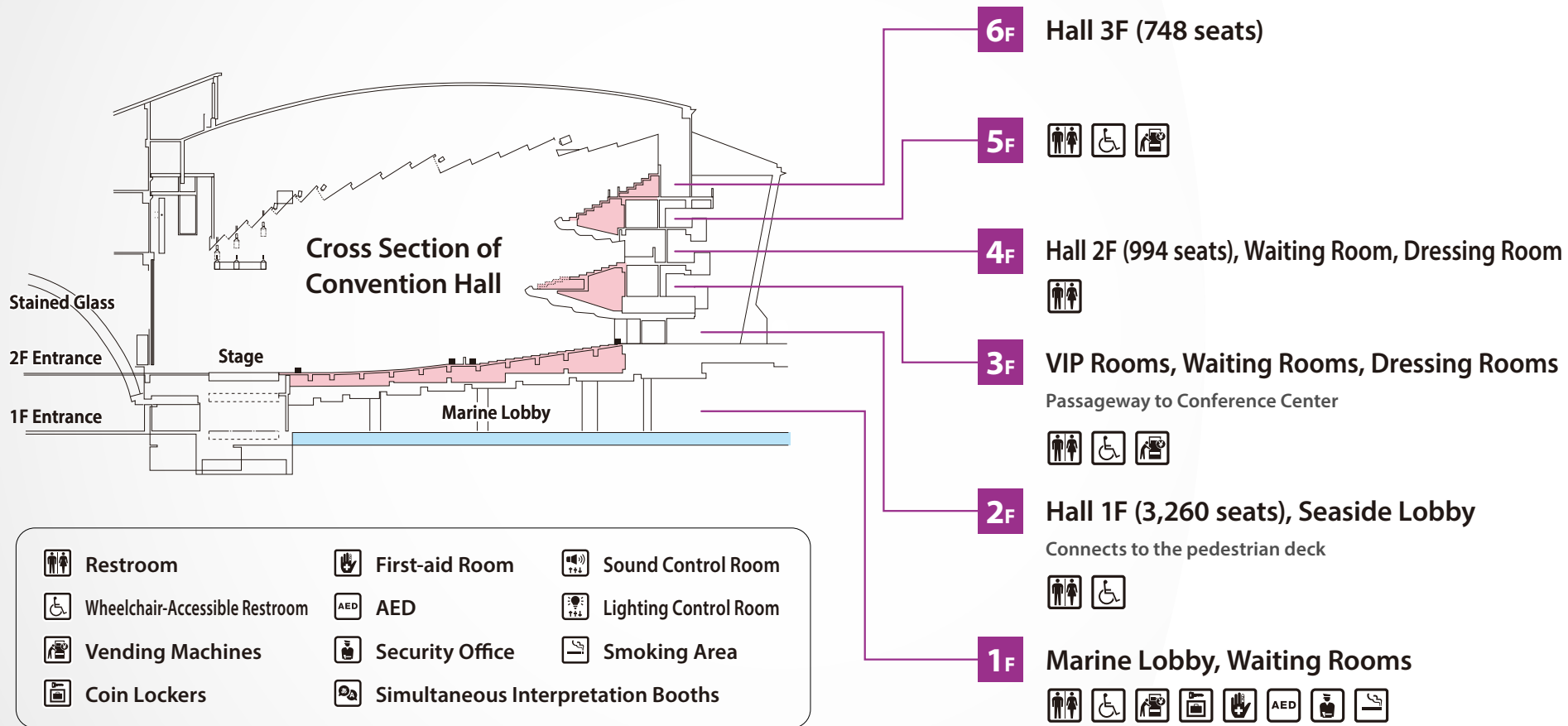

The Marine Lobby facing Yokohama Bay has an attractive interior evoking the image of a seashore.

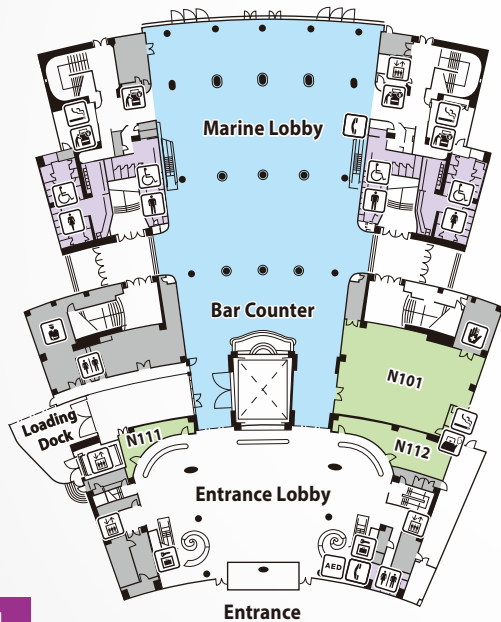

1F

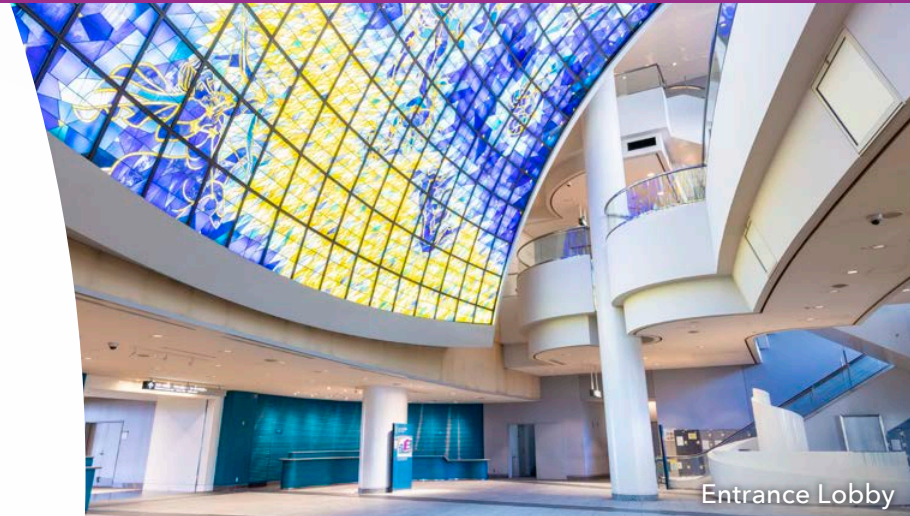

Entrance Lobby



Marine Lobby

# NATIONAL CONVENTION HALL — 2F/3F Floor Plan

PACIFICO YOKOHAMA

The size of the stage can be adjusted as needed. Some seats in odd-numbered rows on the first floor can recline, for a capacity of 1,670.

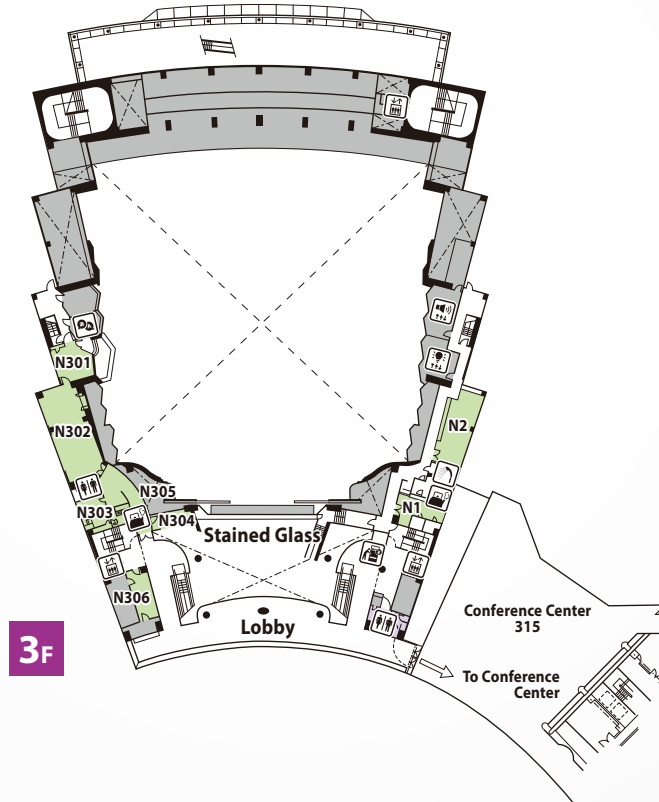
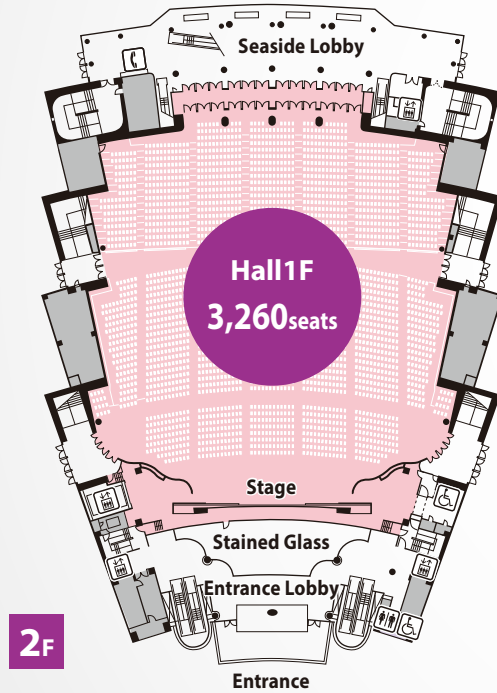

# NATIONAL CONVENTION HALL — 4F/5F/6F Floor Plan

PACIFICO YOKOHAMA

With a total of 5,000 seats on three floors, you can hold large-scale events.

