

NORTH



Exterior that invokes the image of a shoreline

Multi-functional convention center opened in 2020

North is a facility that features the largest multi-purpose hall in Japan. The carpeted and column-free multi-purpose hall accommodates a variety of occasions, such as large parties, company conventions, and conferences. There are also 42 meeting rooms in a variety of sizes that support various modern styles.

New!

facility for
a new generation

6,300
m²

column-free,
carpeted area

42
rooms

in various sizes

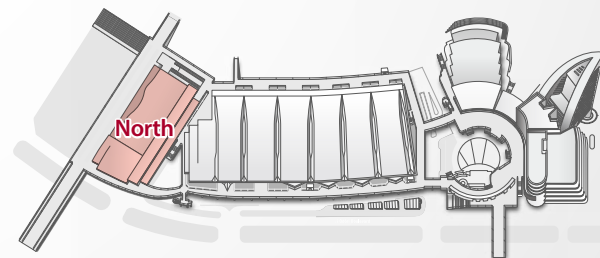

NORTH

PACIFICO YOKOHAMA

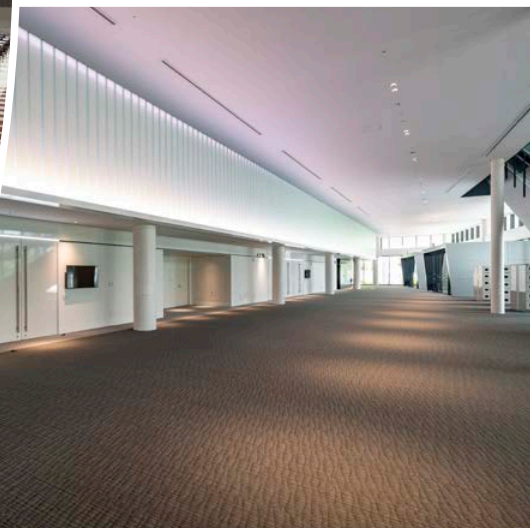
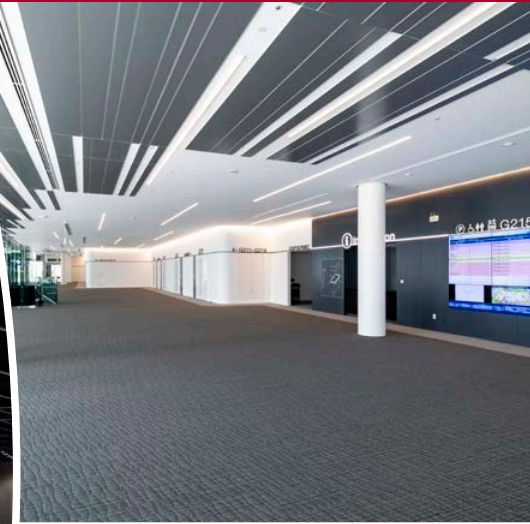

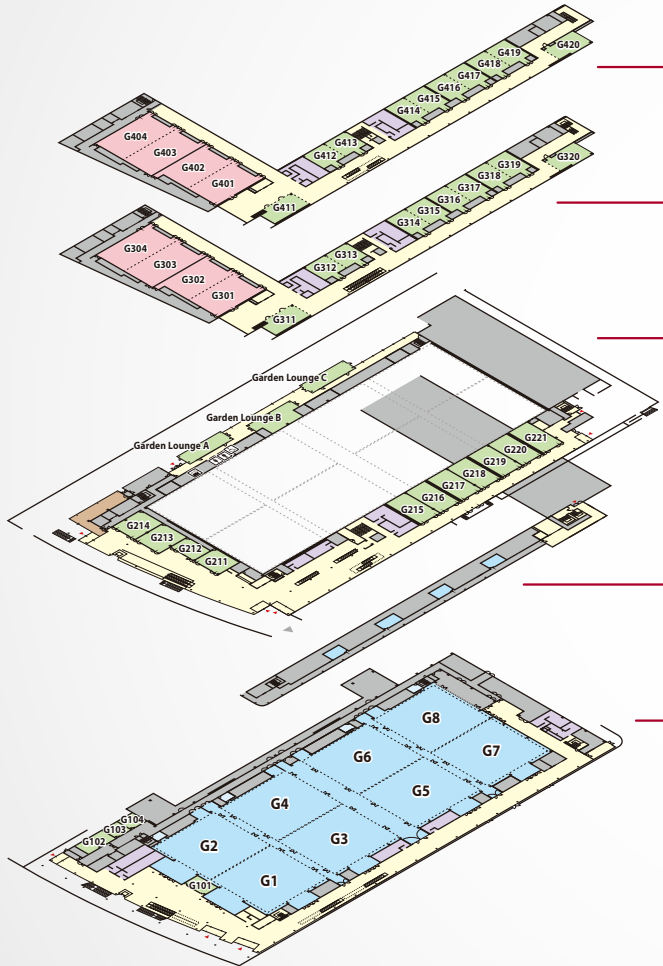

4F

Large/Medium/Small Meeting Rooms



3F

Large/Medium/Small Meeting Rooms



2F

Small Meeting Rooms

DOUTOR COFFEE SHOP

Connects to the pedestrian deck













M2F

Waiting Rooms

1F

Multi-Purpose Hall (6,337 m²),
Waiting Rooms

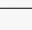

-  Information
-  Self Service Print Corner
-  Restroom
-  Wheelchair-Accessible Restroom
-  Vending Machines
-  Nursing Room
-  Coin Lockers
-  First-aid Room
-  AED
-  Prayer Room
-  Smoking Area

This floor is primarily the 6,300 m² Multi-Purpose Hall, which is the largest in Japan. The carpeted, column-free hall accommodates a variety of occasions, such as large parties, company conventions, and conferences.

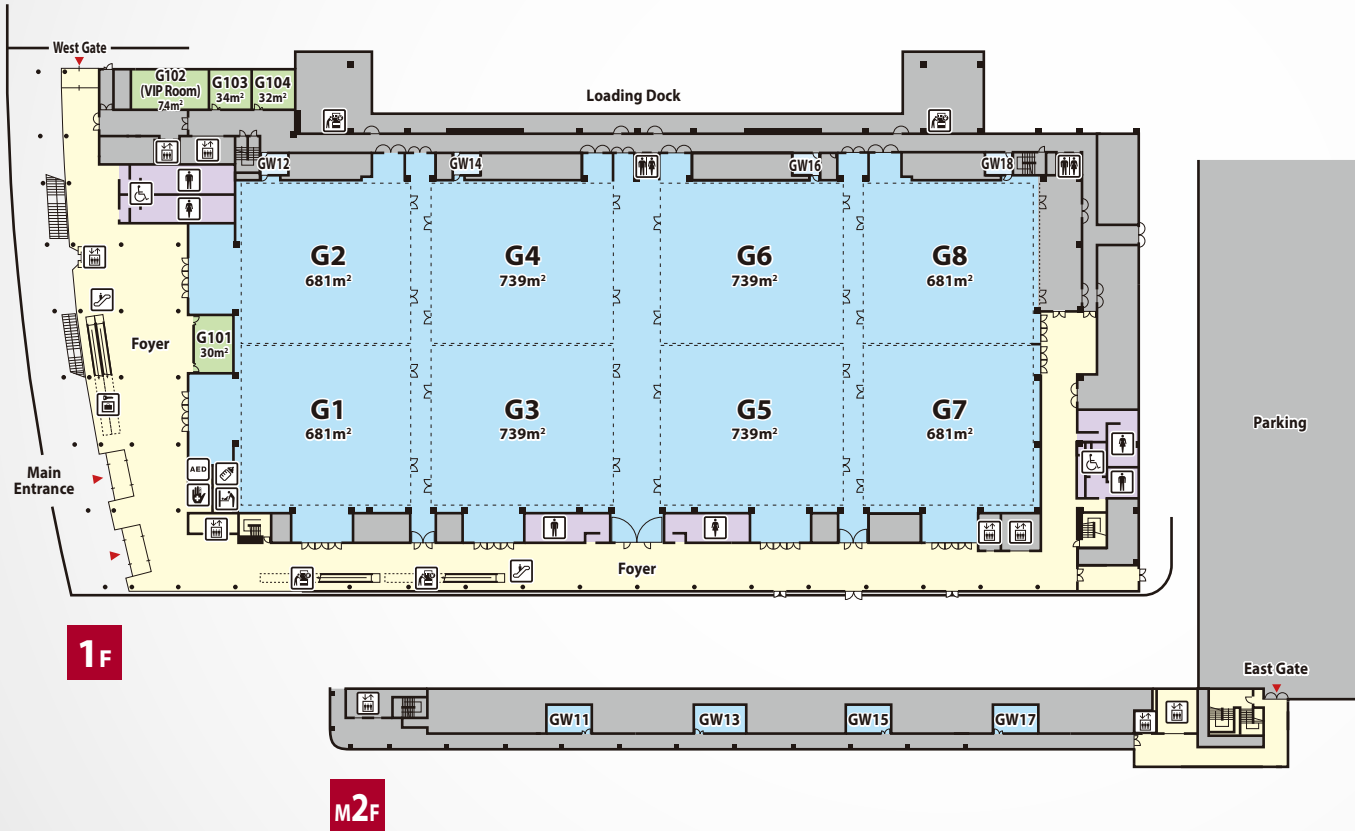

The Main Entrance of the second floor connects to the other PACIFICO Yokohama facilities through a pedestrian deck. This floor has Small Meeting Rooms that can be used as waiting rooms or for seminars for up to 100 people, and it also has Garden Lounges that connect to the outside.

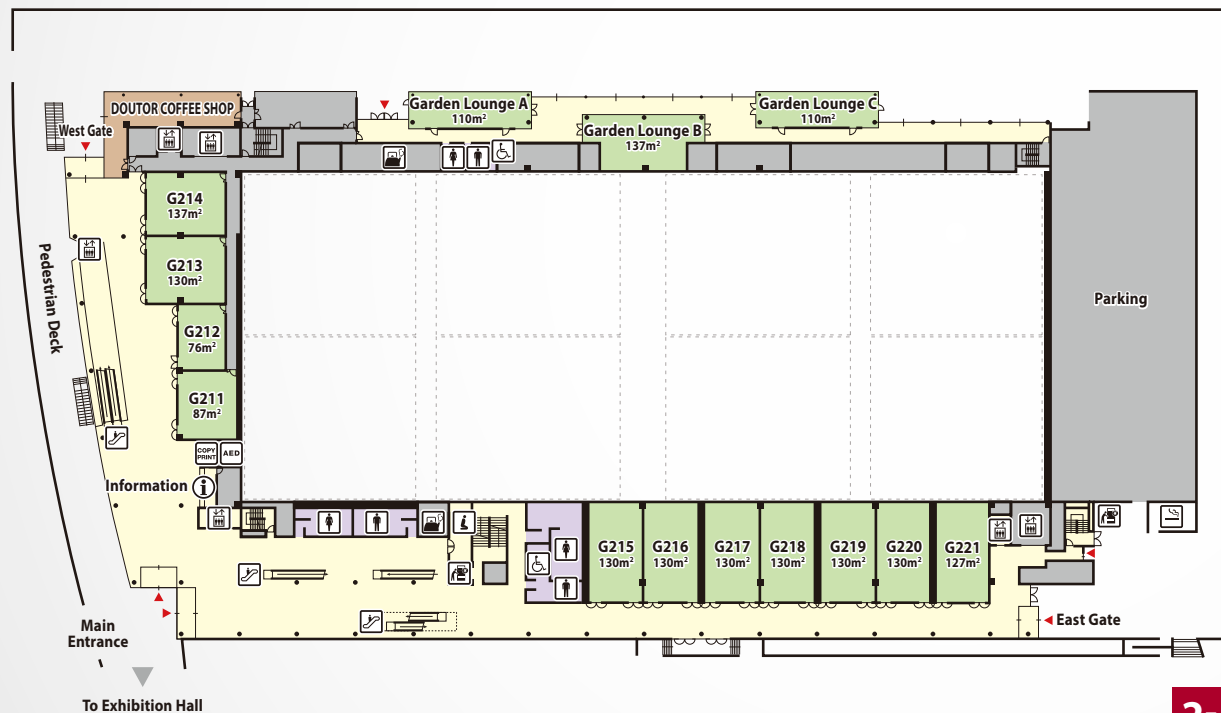

2F



The layout of this floor includes various sizes of rooms, including a Large Meeting Room in a theater layout with a capacity of up to 500 seats. Small and medium conferences, seminars, parties, etc., can all be held on this one floor.



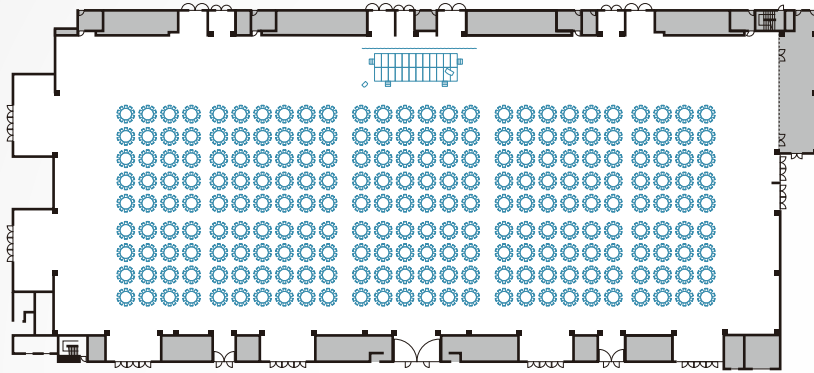

G1-G8 Round table, 2,340 seats

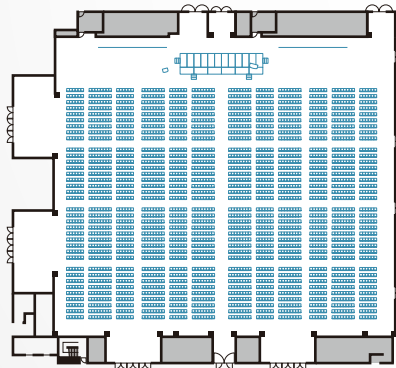

G1-G4 Theater, 3,024 seats

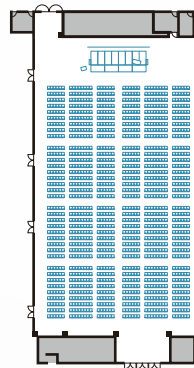

G5 + G6 Theater, 1,440 seats



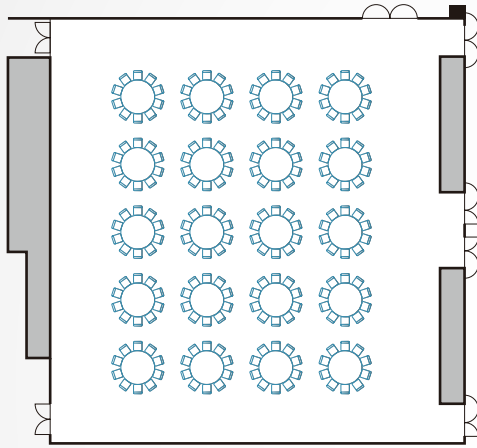

G403 + G404 Round table, 200 seats

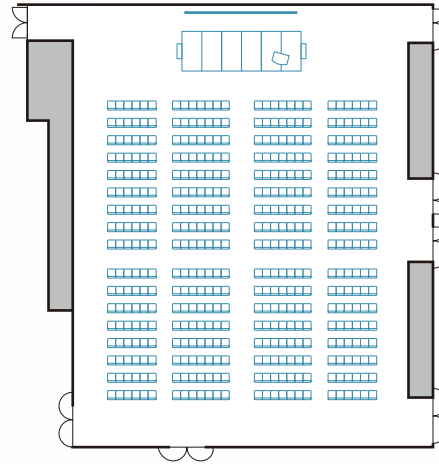

G301 + G302 Theater, 442 seats

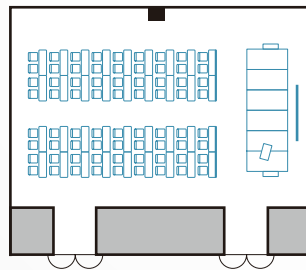

G314 + G315 Classroom, 72 seats



G403 + G404



G301 + G302



G314 + G315